

Deburring Cutter

Entgratfräser



ZCC Cutting Tools Europe GmbH

your Partner | your Value

Deburring Cutter · Entgratfräser

Deburring Cutter 90° Entgratfräser 90°

5501/5601



Coating
Coated

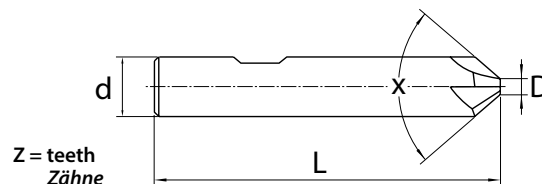

Z = teeth
Zähne

Article no. Artikel Nr.	Dimension (mm) Abmessung					Shank Schaft	P M K		
	d	L	D	Z	X		Grade / Sorte KMG 303		
5501R903FM-0300	3	48	0.2	3	90	HA	●		
5501R904FM-0400	4	48	0.2	4	90	HA	●		
5601R904FM-0600	6	55	0.2	4	90	HB	●		
5601R904FM-0800	8	58	0.5	4	90	HB	●		
5601R904FM-1000	10	65	0.5	4	90	HB	●		
5601R904FM-1200	12	75	0.5	4	90	HB	●		
5601R904FM-1600	16	85	0.7	4	90	HB	○		
5601R906FM-1000	10	65	0.7	6	90	HB	○		
5601R906FM-1200	12	75	0.7	6	90	HB	○		
5601R906FM-1600	16	85	0.7	6	90	HB	○		

Deburring Cutter 60° Entgratfräser 60°

5501/5601



Coating
Coated

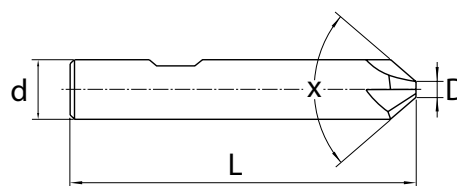

Z = teeth
Zähne

Article no. Artikel Nr.	Dimension (mm) Abmessung					Shank Schaft	P M K		
	d	L	D	Z	X		Grade / Sorte KMG 303		
5501R603FM-0300	3	48	0.2	3	60	HA	●		
5501R604FM-0400	4	48	0.2	4	60	HA	●		
5601R604FM-0600	6	55	0.2	4	60	HB	●		
5601R604FM-0800	8	58	0.5	4	60	HB	●		
5601R604FM-1000	10	65	0.5	4	60	HB	●		
5601R604FM-1200	12	75	0.5	4	60	HB	●		
5601R604FM-1600	16	85	0.7	4	60	HB	○		
5601R606FM-1000	10	65	0.7	6	60	HB	○		
5601R606FM-1200	12	75	0.7	6	60	HB	○		
5601R606FM-1600	16	85	0.7	6	60	HB	○		

Corner Radius Cutter Viertelkreisfräser

5601



Coating
Coated

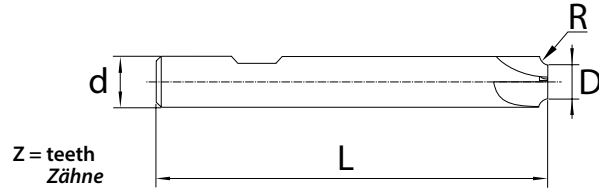

Article no. Artikel Nr.	Dimension (mm) Abmessung					Shank Schaft	P M K Grade / Sorte KMG 303
	d	L	D	Z	R		
5601R904FM-R02-0600	6	60	5.6	4	0.2	HB	•
5601R904FM-R03-0600	6	60	5.4	4	0.3	HB	•
5601R904FM-R04-0600	6	60	5.2	4	0.4	HB	•
5601R904FM-R05-0800	8	70	7.0	4	0.5	HB	•
5601R904FM-R06-0800	8	70	6.8	4	0.6	HB	•
5601R904FM-R075-0800	8	70	6.5	4	0.75	HB	•
5601R904FM-R08-0800	8	70	6.4	4	0.8	HB	•
5601R904FM-R10-0800	8	70	6.0	4	1.0	HB	•
5601R904FM-R15-1000	10	75	7.0	4	1.5	HB	•
5601R904FM-R20-1000	10	75	6.0	4	2.0	HB	•
5601R904FM-R25-1200	12	75	7.0	4	2.5	HB	•
5601R904FM-R30-1200	12	75	6.0	4	3.0	HB	•
5601R904FM-R40-1600	16	80	8.0	4	4.0	HB	•
5601R904FM-R50-2000	20	80	10.0	4	5.0	HB	•

Quarter Radius Cutter
Viertelkreisfräser

Recommended Cutting Data Empfohlene Schnittdaten

Material Werkstoffe		D (mm)	Vc (m/min)	Feed rate Vorschub fz (mm/Z)	Material Werkstoffe		D (mm)	Vc (m/min)	Feed rate Vorschub fz (mm/Z)
P	Steel Stahl	3	70-120	0,01	K	Cast iron Guss	3	90	0,01
		4	70-120	0,02			4	90	0,02
		6	70-120	0,03			6	90	0,03
		8	70-120	0,04			8	90	0,04
		10	70-120	0,05			10	90	0,05
		12	70-120	0,06			12	90	0,06
		16	70-120	0,08			16	90	0,08
M	Stainless Steel Rostfreier Stahl	3	60-90	0,01	N	Non ferrous Materials Ne-Metalle	3	200-280	0,01
		4	60-90	0,02			4	200-280	0,02
		6	60-90	0,03			6	200-280	0,03
		8	60-90	0,04			8	200-280	0,04
		10	60-90	0,05			10	200-280	0,05
		12	60-90	0,06			12	200-280	0,06
		16	60-90	0,08			16	200-280	0,08



Scan for PDF

Deburring Cutter Entgratfräser



Sales center in Europe
Vertriebszentrale in Europa

ZCC Cutting Tools Europe GmbH

www.zccct-europe.com

Wanheimer Str. 57, 40472 Düsseldorf, Germany

Tel.: +49(0)211-989240-0

Fax: +49(0)211-989240-111

E-Mail: info@zccct-europe.com

Sales center in France
Vertriebszentrale in Frankreich

ZCC Cutting Tools Europe GmbH Succursale Française

www.zccct-europe.com

14, Allée Charles Pathé, 18000 Bourges, France

Tel.: +33 (0)2-454101-40

Fax: +33 (0)2-486619-46

E-Mail: ventes@zccct-europe.com

© Copyright by ZCC Cutting Tools Europe GmbH
All rights reserved. / Alle Rechte vorbehalten.

All rights reserved. All descriptions and pictures are protected by copyright. Usage, modification and reproduction, completely or partially, without written permission are prohibited. Subject to technical changes and changes of the delivery program. Mistakes and printing errors are reserved.

Alle Rechte vorbehalten. Alle Beschreibungen und Abbildungen sind urheberrechtlich geschützt. Die Verwendung, Modifikation und Vervielfältigung, ganz oder teilweise, ohne schriftliche Genehmigung sind untersagt. Technische Änderungen und Änderungen des Lieferprogrammes vorbehalten. Für Druckfehler und Irrtümer keine Gewähr.